

WILBUR ELLIS
SUITE REDUCTION
#23 - 1501 LONSDALE AVE.
NORTH VANCOUVER, BC.

OWNER C/O: AUSTEVILLE
DRAWING NO. 17036G1A
MARCH 13, 2016

LEGEND

- EXISTING WALL, CONSTRUCTION
- EXISTING FURNITURE

EXISTING

AREA SUMMARY (RENTABLE)		
EXISTING UNIT #23	1,915	SQ.FT.

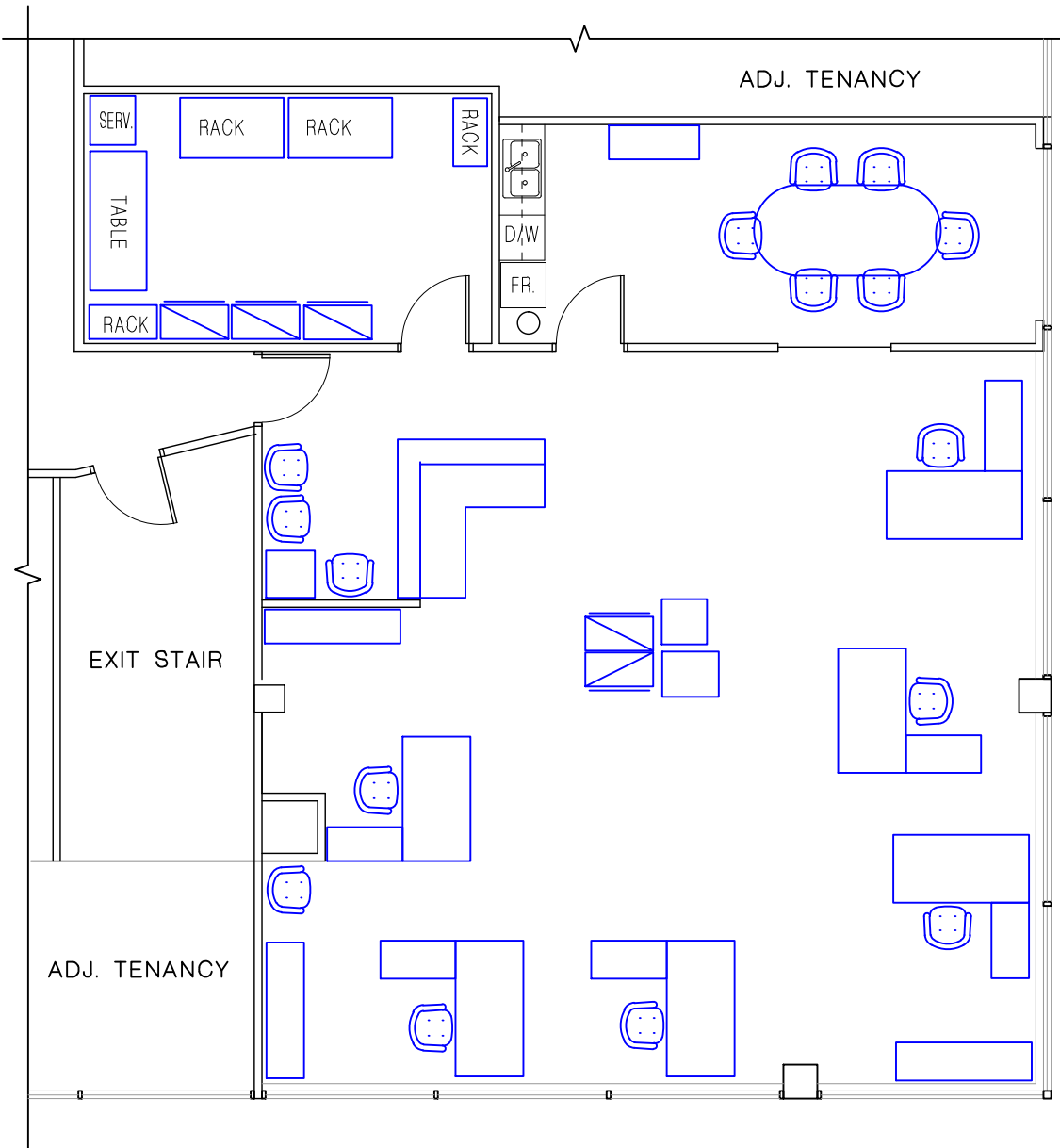

UNIT 23 FLOOR PLAN

SCALE: 1/8" = 1'-0"